

## PEARL STREET OFFICE SPACE FOR LEASE

1320 Pearl Street, Boulder, CO 80302

# THE CARTWRIGHT BUILDING



### ABOUT THE BUILDING

Office suites available for lease at The Cartwright Building, an office / retail building located on the historic Pearl Street Mall. Situated between 13th and 14th across from the Boulder Court House, this building provides all of Downtown Boulder's fantastic shops and restaurants just steps away from your door.

- 308 SF - 1,075 SF available for lease
- Upgraded finishes throughout the building
- Rooftop deck area

**CHAD HENRY**

chenry@wwreynolds.com

**DREW WEIMAN**

drew@wwreynolds.com

THE  
*W.W. Reynolds*  
COMPANIES

P. 303-442-8687

www.wwreynolds.com



1320 PEARL STREET, BOULDER, CO 80302

# THE CARTWRIGHT



**CHAD HENRY**

chenry@wwreynolds.com

**DREW WEIMAN**

drew@wwreynolds.com

WWW.WWREYNOLDS.COM

P. 303-442-8687



1320 PEARL STREET, BOULDER, CO 80302

# FLOOR PLAN

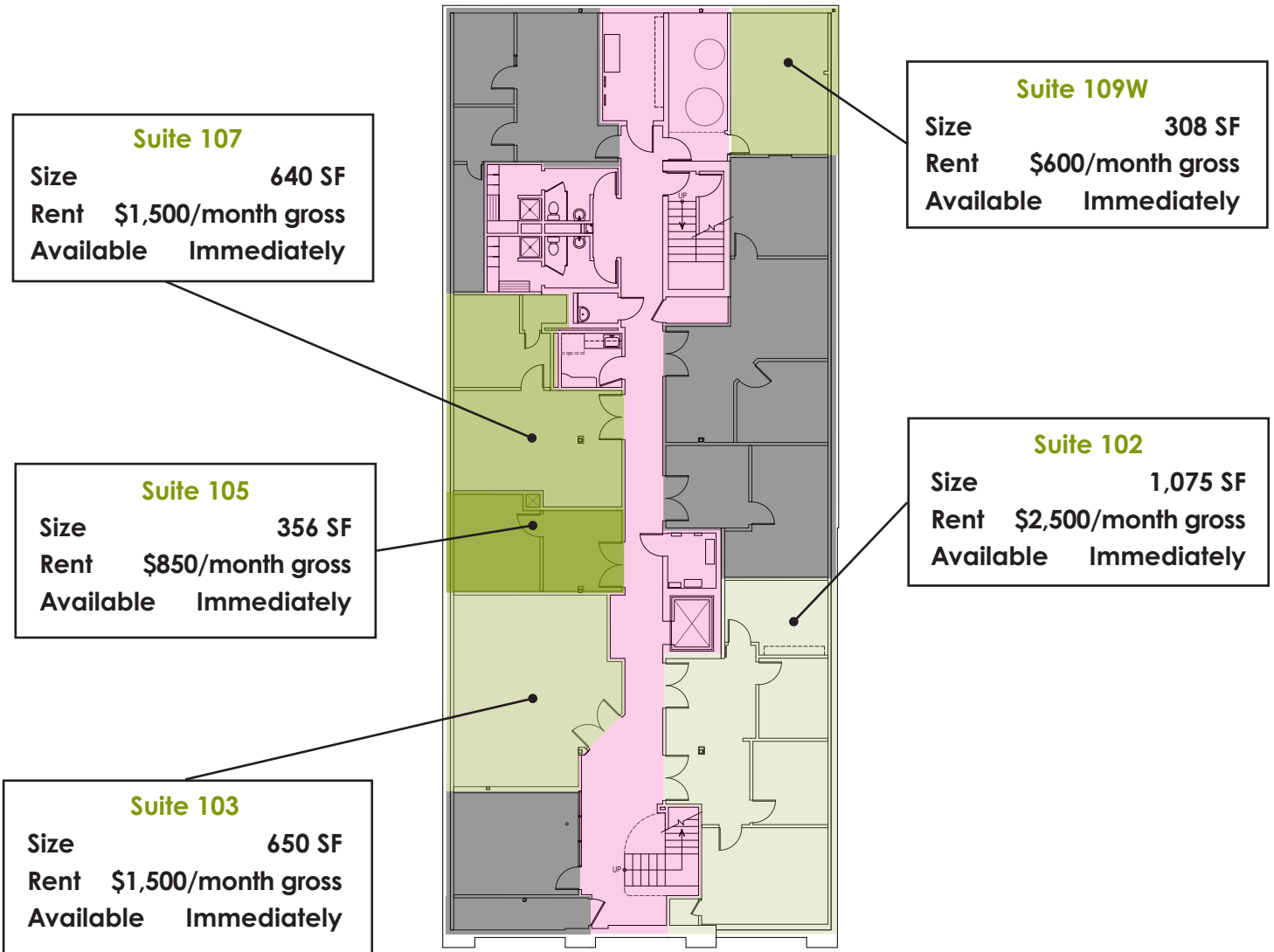

**CHAD HENRY**

chenry@wwreynolds.com

**DREW WEIMAN**

drew@wwreynolds.com

