

FAÇADE GRANT (DIP)  
APPLICATION FORM

Applicant

Name of Business St. Vrain Historical Society, Inc.  
Contact Name Angela Anderson / Alyce Davis  
Address P.O. Box 705, Longmont CO 80502  
Telephone Work 303-776-1870 <sup>Angie</sup> Home 720-635-4175  
Email office@stvrainhistory.org / angieanderson1441@gmail.com

Project Information

Building Address 470 Main Street  
Legal Description See attached  
Year built 1881 Is this a historic property? ☒ Yes ☐ No  
Is there a formal historic designation of the property? ☒ Yes ☐ No  
Ownership St. Vrain Historical Society, Inc.

Property Owner (if different from applicant). Please attach property owner permission document to application.

Contact Name N/A  
Phone \_\_\_\_\_  
Email \_\_\_\_\_  
Mailing Address \_\_\_\_\_

Lease term (if applicable) \_\_\_\_\_ Lease expiration date \_\_\_\_\_

Description of Façade Project (include all work to be completed, even those items not eligible in the Façade Grant, i.e. interior improvements, roofing, etc.)

See attached

Briefly describe how your project meets the Goals and Strategies of the Downtown Longmont Master Plan of Development.

See attached

Project Schedule (Attach time line for completion, if one exists)

Start Date IN Progress End Date April 30, 2023

Source of Funds for the Project

a. Great American Insurance \$ Unknown - the claim is still being reviewed and we will update you as soon as we receive information from them

b. Donations \$ 2,100 so far

Total Cost of Project \$ 33,121  
(include all improvement costs)

Total Cost of Façade Renovation \$ 33,121

Façade Grant (DIP) Request \$ 8,280.25  
(25% of Façade Renovation cost, \$10,000 maximum)

Total Grant Request should be based on bids you plan to use for your project. Applicant is not required to use low bid. If using higher bid, applicant should note on the bid the reason for choosing the high bid.

Applicant, by virtue of signature on this applicant document and upon acceptance of funds provided by the Longmont Downtown Development Authority agrees to the terms and requirements of the Façade Grant (DIP).

9/22/22  
Date

Angela Anderson  
Signature

Legal Description:

W 72.6 FT OF LOT 1 & N 22.28 FT OF W 72.6 FT OF LOT 2 LESS S 6.45 FT OF N 22.28 FT OF W 54.41 FT OF LOT 2 BLOCK 51 LONGMONT OT DPT EXEMPTION FILE NO 07-01197-01

Description of Façade Project:

- Restoration and or reproduction of the stained glass windows that were damaged in the two vandalism incidents that took place on August 11, 2022, and on August 24, 2022. There is a total of 12 damaged stained glass windows. 10 windows are being repaired by Lucia's Glass in Fort Collins, these are the reproduction widows which were made around 43 years ago (3M, 6T, 6M, 6B, 7T, 7M, 7B, 8T, 8M, 8B). Two of the windows Angela Anderson is donating her time to repair (windows 11 & 12), these were made by her in 2010 as part of the Past President, David Schey Memorial.
- Replacement of the damaged safety glass panels (windows 6, 7, 8, 11 and 12) and replacing the remaining existing safety glass with a polycarbonate which will hold up to vandalism in the future. This also includes adding a polycarbonate covering to the bottom windows of 1, 2, 3, 6, 7, and 8, where there is no current protection and to the clear glass windows 13 and 14, on the east side of the Church. The current safety glass is laminated glass which is easily broken.

Briefly describe how your project meets the Goals and Strategies of the Downtown Longmont Master Plan of Development:

This is part of a rehabilitation project that will bring the "Old" St. Stephen's Church up to standards in keeping with maintaining the historic character and identity of the Downtown Creative District. Additionally, this project will further protect this historic building while showcasing Longmont's unique history. These changes, especially with the addition of the polycarbonate glass will also uphold the goals of the master plan by deterring future vandalism and thus making the St. Stephen's Plaza a safe and welcoming space for all.

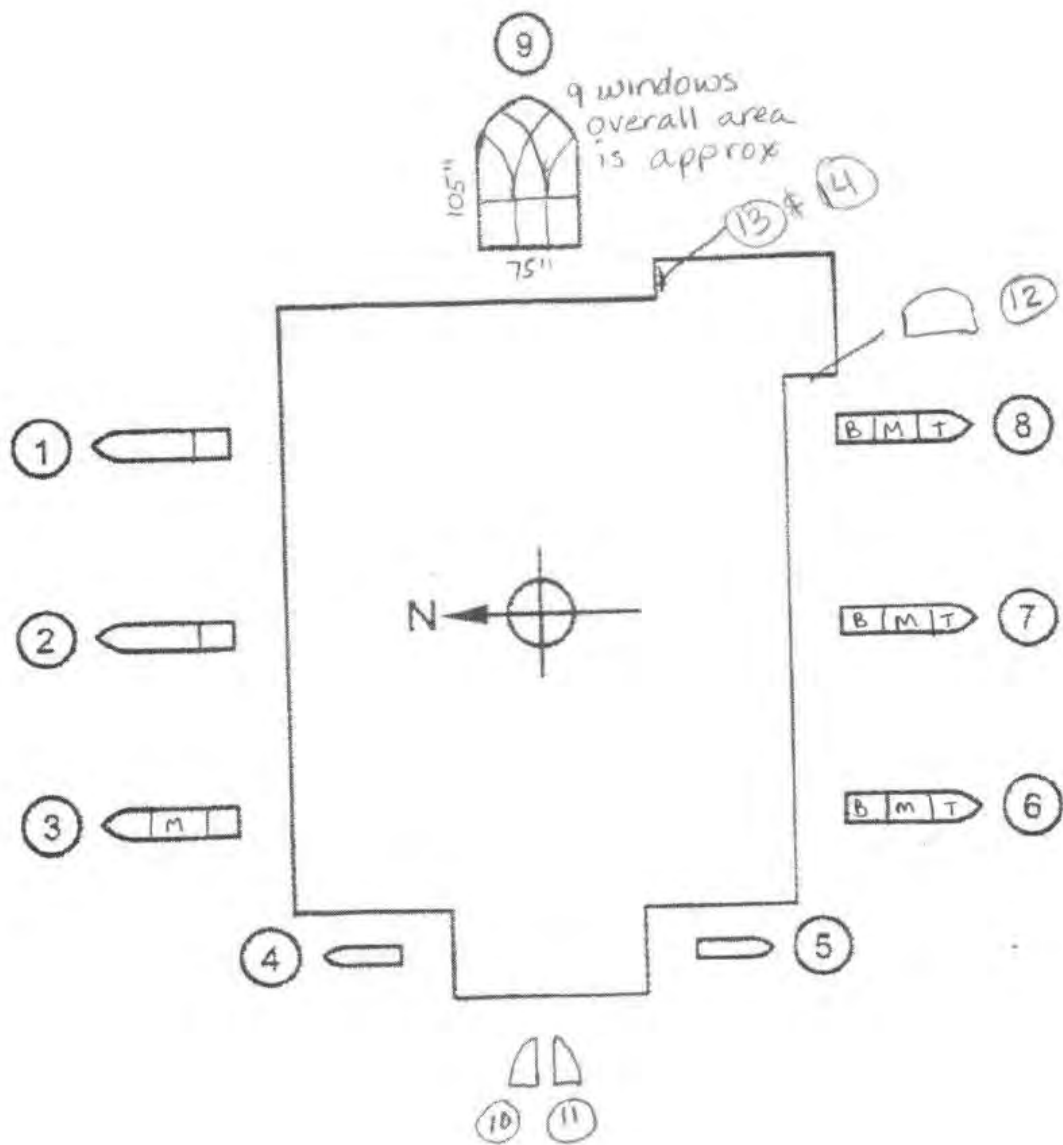

8/24/22 #3M damage



4 pieces total  
2 green  
1 yellow  
Hand painted wing

8/24/22 #6T damage



11 Pieces broken plus one possible  
5 orange  
6 yellow  
Possible green piece



8/24/22 #6M damage



3 pieces total

3 yellow

8/24/22 #6B damage



Approximately 23 pieces total

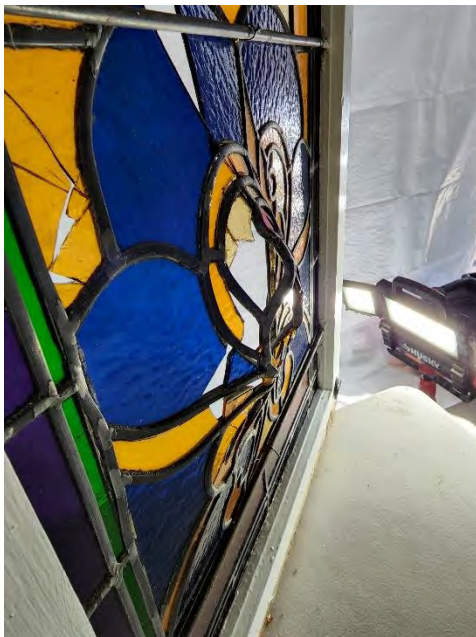



8/24/22 #7T damage

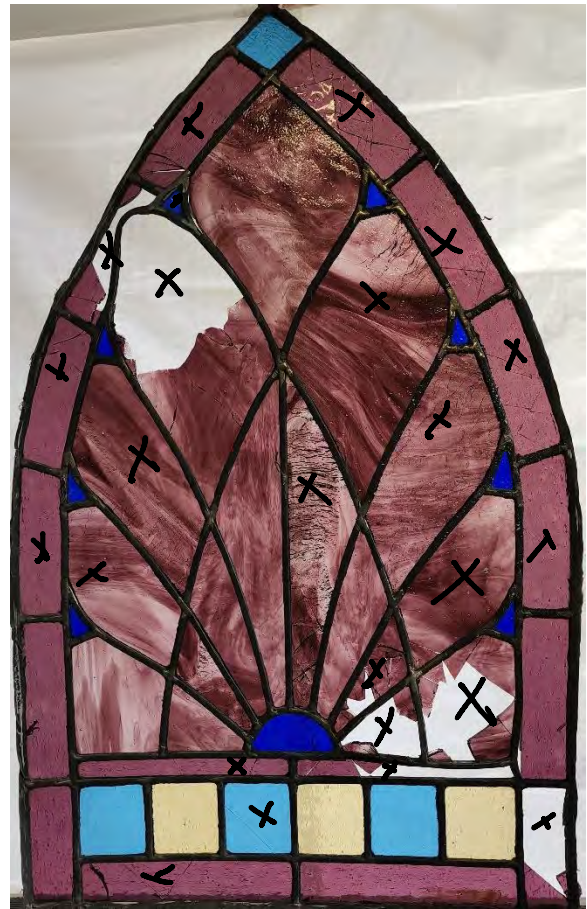

8/11/22 #7M damage



7 Total  
2 yellow  
3 purple  
2 blue (possibly 4)

8/24/22 #7B damage



26 pieces total  
12 orange  
10 yellow  
3 light blue  
1 brown



8/24/22 #8T damage

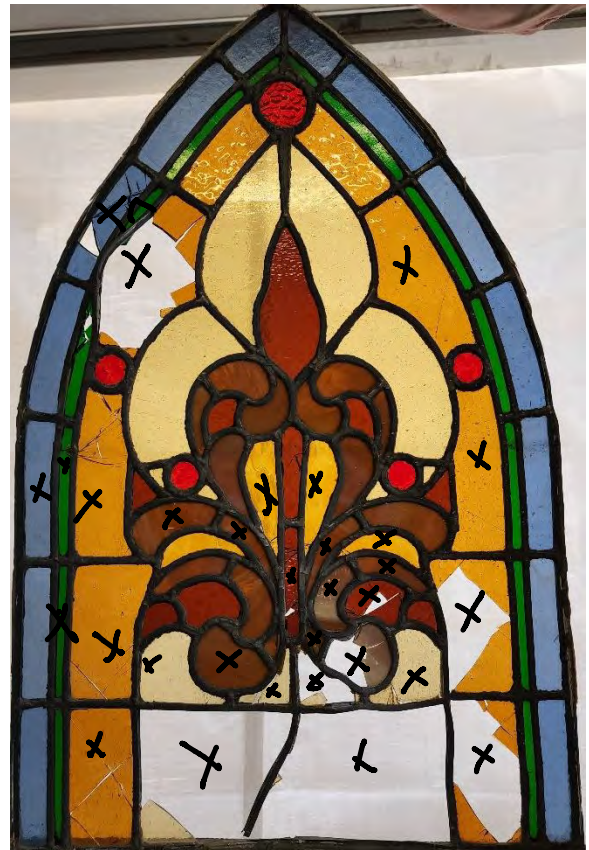

27 pieces total  
2 blue  
3 green  
8 orange  
2 orange textured  
3 yellow textured  
9 multi colored

8/24/22 #8M damage



8 Pieces broken, plus one possible piece

4 green

2 orange

1 yellow

1 red

Possibly right side of the painted piece



8/24/22 #8B damage



19 pieces total

8/11/22 #11 damage



16 pieces total  
6 brown  
4 yellow  
6 white

8/24/22 #12 damage



7 pieces total



Angie Anderson &lt;angieanderson1441@gmail.com&gt;

---

**Re: St. Vrain Historical Society**

1 message

---

**Ed Lucia** <edlucia100@gmail.com>

Sat, Sep 17, 2022 at 2:27 PM

To: Angie Anderson &lt;angieanderson1441@gmail.com&gt;

Hi Angela,

I studied the damage to all 10 windows. There are a few that need total restoration, while the others can be repaired in only the areas which were damaged. My total bid will not exceed \$15,000. This includes all materials, total repair and transport. I will keep a log as to the hours I put in at \$50.00 per hour along with the occasional hours of an assistant at \$25.00 an hour. I will pick up and already paid for the glass at D&L.

I have an A frame rack to transport the damaged windows and the return of the finished windows to the site. I have a \$2,000,000 liability policy with State Farm. I will provide pictures as the work progresses. I will need a 50% deposit to proceed.

Thanks Angie

Ed Lucia  
Lucia's Glass

**From:** [Angie Anderson](#)  
**To:** [Del Rae Heiser](#)  
**Cc:** [St. Vrain Historical Society](#)  
**Subject:** Re: [External] Facade grant  
**Date:** Friday, September 23, 2022 12:24:50 PM

---

Yes, \$15,000.00.

Thanks for asking.

Angie

On Fri, Sep 23, 2022, 12:18 PM Del Rae Heiser <[DelRae.Heiser@longmontcolorado.gov](mailto:DelRae.Heiser@longmontcolorado.gov)> wrote:

Hi again,

Ed Lucias's email said the repair of the stained glass shouldn't exceed \$15,0000. Angie told me it shouldn't exceed \$15,000 so just wanted to clarify. I'm sure it's just a typo but should address this in case the Board should ask. ☺ Thx!

Del Rae

---

**From:** St. Vrain Historical Society <[office@stvrainhistory.org](mailto:office@stvrainhistory.org)>  
**Sent:** Thursday, September 22, 2022 3:57 PM  
**To:** Del Rae Heiser <[DelRae.Heiser@longmontcolorado.gov](mailto:DelRae.Heiser@longmontcolorado.gov)>  
**Cc:** 'Angie Anderson' <[angieanderson1441@gmail.com](mailto:angieanderson1441@gmail.com)>  
**Subject:** [External] Facade grant  
**Importance:** High

Hi Del Rea,

Here is our façade grant and our 2020 990 and 2019 990.

We are still waiting on the second bid from the Riot Glass LLC. Angie has been trying since the end of August to get this from our contact. She has been out of the office and just got back so I am sure there is some catching up that she needs to do. As soon as we get this we will pass it on.



Our apologies about this, we just wanted to make sure that you all have something here soon.

If you have any questions please let us know!

Alyce

Alyce DeSantis, MNM

The St. Vrain Historical Society, Inc.

(303)776-1870

P.O. Box 705

Longmont, CO 80502

*“Assuring a Future for Our Community’s Past”*

**From:** Angie Anderson [<mailto:angieanderson1441@gmail.com>]

**Sent:** Thursday, September 22, 2022 3:31 PM

**To:** Office@SVHS

**Subject:** Facade grant

--

Angie Anderson

720-635-4175

[angieanderson1441@gmail.com](mailto:angieanderson1441@gmail.com)

THE ST. VRAIN HISTORICAL SOCIETY INC.

GRANT ACCOUNT  
P.O. BOX 705  
LONGMONT, CO 80502-0705

82-62/1070  
138118

1164

DATE

9/20/2022

PAY TO THE  
ORDER OF

Lucia's Glass

\$ 7,500.00

Seven Thousand, Five Hundred Dollars + 00/100

DOLLARS



Security Features  
Indicated  
Details on Back



FirstNational  
BANK OF LONGMONT

P.O. Box 1144  
Longmont, Colorado 80501-1144  
Telephone 303-778-9800

TWO SIGNATURES REQUIRED

*[Signature]*

*[Signature]*

MP

MEMO

OSS window's

8. PLEASE WRITE ON REVERSE

11/12/14



1770 38<sup>th</sup> Street Boulder, CO 80301  
303-442-3662 FAX: 303-442-4537

504 5<sup>th</sup> Ave, Longmont, CO 80501  
303-776-3400 FAX: 303-651-6253

SLADEGLASS.COM

*Your Most Trusted Source for Everything Glass Since 1961*

### **Proposal**

DATE: 9/12/2022

PROPOSAL SUBMITTED TO: St.Vrain Historical Society, Inc

SGC WORK ORDER: 14892

JOB ADDRESS: 470 Main St. Longmont, CO 80501

PHONE NUMBER: 720-635-4175

EMAIL: [angieanderson1411@gmail.com](mailto:angieanderson1411@gmail.com), [office@stvrainhistory.org](mailto:office@stvrainhistory.org)

---

SLADE GLASS CO., PROPOSES TO FURNISH AND INSTALL MATERIALS AS FOLLOWS:

#### **Windows 1 - 3**

3 - 28 x 68 Clear 3/16 polycarbonate to be installed into the existing frames. *\*Patterned*  
3 - 28 x 34 Stationary storm windows with 1/8 polycarbonate to be installed into the existing opening.  
3 - 28 x 34 New Screens per pattern

#### **Windows 4 & 5**

2 - 20 x 60 Clear 3/16 polycarbonate to be installed into the existing frames. *\*Patterned*

#### **Windows 6 - 8**

3 - 28 x 68 Clear 3/16 polycarbonate to be installed into the existing frames. *\*Patterned*  
3 - 28 x 34 Stationary storm windows with 1/8 polycarbonate to be installed into the existing opening.  
3 - 28 x 34 New Screens per pattern

#### **Window 9**

6 - 26 x 36 Clear 3/16 polycarbonate to be installed into the existing frames. *\*Patterned*  
3 - 26 x 36 Clear 3/16 polycarbonate to be installed into the existing frames.

#### **Windows 10 & 11**

2 - 26 x 14 Clear 3/16 polycarbonate to be installed into the existing frames.. *\*Patterned*

#### **Window 12**

1 - 36 x 16 Clear 3/16 polycarbonate to be installed into the existing frames.. *\*Patterned*

#### **Windows 13 - 14**

2 - 28 x 24 Stationary storm windows with 1/8 polycarbonate to be installed into the existing opening.

**Materials, Tax and Labor: \$ 18,121.00**

**Please Note that no framing or wood/vinyl stop will be provided on or for any *\*Patterned* materials. Existing materials will need to be reused if possible or you will need to contact a carpenter. More information will be available after the final measure takes place.**

- *Above price is based on same trip installation.*
- *Slade Glass requires a 50% non refundable deposit, prior to ordering custom materials*
- *Slade Glass requires a cleared workspace, i.e. all window treatments and furniture must be removed or moved prior to installation.*
- *When customer's existing materials are re-used, Slade Glass CO. shall not be responsible for breakage or damages to those materials*

Respectfully submitted by Samantha Davis

ACCEPTED:

Name: \_\_\_\_\_

Date: \_\_\_\_\_

Signature: \_\_\_\_\_

THIS PROPOSAL IS SUBJECT TO THE FOLLOWING TERMS AND CONDITIONS HEREOF.

- **TERMS: NET 30 DAYS WITH APPROVED CREDIT OR A 50% DEPOSIT SHALL BE REQUIRED ON CUSTOM MATERIALS.** IF A CREDIT CARD IS USED FOR THE DEPOSIT, IT SHALL REMAIN ON FILE UNTIL THE JOB IS FINISHED AND THE REMAINING BALANCE SHALL BE RUN WITHIN 48 HOURS OF JOB COMPLETION. THE CREDIT CARD NUMBER SHALL BE DESTROYED AFTER COMPLETION OF THIS CONTRACT
- **BALANCE IS DUE IN FULL UPON COMPLETION OF THE INSTALLATION.** ALL SUMS NOT PAID WHEN DUE SHALL BEAR INTEREST AT THE RATE OF 1 ½% PER MONTH FROM THE DATE DUE UNTIL PAID, OR AT THE MAXIMUM LEGAL RATE PERMITTED BY LAW WHICHEVER IS LESS. SLADE GLASS CO. SHALL BE ENTITLED TO ALL COSTS OF COLLECTION, INCLUDING COURT COSTS AND REASONABLE ATTORNEY'S FEES.
- WE GUARANTEE OUR WORKMANSHIP FOR ONE YEAR, HOWEVER WHEN CUSTOMER'S EXISTING MATERIALS ARE RE-USED, SLADE GLASS CO. SHALL NOT BE RESPONSIBLE FOR BREAKAGE OR DAMAGES TO THOSE MATERIALS.
- ALL WORK SHALL BE PERFORMED DURING OUR REGULAR WORKING HOURS. EXTRA CHARGES WILL APPLY FOR ALL WORK PERFORMED OUTSIDE OUR REGULAR WORKING HOURS.
- PRICING ON THIS PROPOSAL IS BASED ON ALL ITEMS LISTED TO BE INSTALLED IN ONE SINGLE TRIP. IF ITEMS ARE ORDERED TO BE INSTALLED AT SEPARATE TIMES, ADDITIONAL TRIP CHARGES SHALL BE ADDED.
- FINAL CLEANING IS EXCLUDED.
- PAINTING AND STAINING ARE EXCLUDED (IF APPLICABLE).
- DUE TO THE LACK OF FRAMING ON EUROPEAN SHOWER ENCLOSURES, SLADE GLASS CO SHALL NOT WARRANTY AGAINST LEAKAGE.
- WOOD SUPPORT OR BACKING IS REQUIRED FOR WALL MOUNT EUROPEAN SHOWER ENCLOSURES. THIS BLOCKING AND THE COST OF INSTALLATION ARE EXCLUDED
- SLADE GLASS CO. SHALL NOT BE RESPONSIBLE FOR DAMAGES TO THE TILE IN SHOWER INSTALLATIONS
- MOVING FURNITURE, REMOVAL, AND RE-INSTALLATION OF WINDOW COVERINGS ARE EXCLUDED.
- SLADE GLASS CO RETAINS ALL OF THE COPYRIGHT AND OTHER INTELLECTUAL PROPERTY RIGHTS FOR ANY JOB-SITE PHOTOGRAPHS TAKEN.
- THIS PROPOSAL MAY BE WITHDRAWN IF NOT ACCEPTED WITHIN 30 DAYS OF THE ABOVE DATE.