

APPENDIX I: GRANT APPLICATION

Date of Application:			
Building/Property Address:	631 Madison Ave. Memphis, TN 38103		
Applicant's Name:	Ben Colar		
Name of the Business:	Colar Ventures LLC		
Ownership Status:	<input type="checkbox"/> I own the property <input type="checkbox"/> I am purchasing the property <input checked="" type="checkbox"/> I will lease the property <input type="checkbox"/> Other _____		
Exact size of the space to be leased (sq. ft.)	1600		
Describe the length and monthly rent of your proposed lease:	5 Year lease. \$2,480 per month.		
Primary Project Contact:	Name: Ben Colar Phone: 7737109440 Email: ben@bencolar.com Mailing Address: 1034 Stonewall St. Memphis, TN 38107		
Proposed Improvements: (check all that apply)	<table border="0"> <tr> <td style="vertical-align: top;"> <input type="checkbox"/> Hazardous material abatement <input checked="" type="checkbox"/> Interior demolition <input checked="" type="checkbox"/> ADA Compliance <input checked="" type="checkbox"/> Plumbing <input checked="" type="checkbox"/> Electrical <input checked="" type="checkbox"/> Mechanical/HVAC <input checked="" type="checkbox"/> Permanent Lighting </td> <td style="vertical-align: top;"> <input type="checkbox"/> Flooring <input type="checkbox"/> Windows/Doors <input type="checkbox"/> Permanent interior walls <input checked="" type="checkbox"/> Historic restoration <input checked="" type="checkbox"/> Cash wrap/bar/counter <input type="checkbox"/> Other (describe below) </td> </tr> </table>	<input type="checkbox"/> Hazardous material abatement <input checked="" type="checkbox"/> Interior demolition <input checked="" type="checkbox"/> ADA Compliance <input checked="" type="checkbox"/> Plumbing <input checked="" type="checkbox"/> Electrical <input checked="" type="checkbox"/> Mechanical/HVAC <input checked="" type="checkbox"/> Permanent Lighting	<input type="checkbox"/> Flooring <input type="checkbox"/> Windows/Doors <input type="checkbox"/> Permanent interior walls <input checked="" type="checkbox"/> Historic restoration <input checked="" type="checkbox"/> Cash wrap/bar/counter <input type="checkbox"/> Other (describe below)
<input type="checkbox"/> Hazardous material abatement <input checked="" type="checkbox"/> Interior demolition <input checked="" type="checkbox"/> ADA Compliance <input checked="" type="checkbox"/> Plumbing <input checked="" type="checkbox"/> Electrical <input checked="" type="checkbox"/> Mechanical/HVAC <input checked="" type="checkbox"/> Permanent Lighting	<input type="checkbox"/> Flooring <input type="checkbox"/> Windows/Doors <input type="checkbox"/> Permanent interior walls <input checked="" type="checkbox"/> Historic restoration <input checked="" type="checkbox"/> Cash wrap/bar/counter <input type="checkbox"/> Other (describe below)		
If you listed <i>Other</i> above, Please briefly describe			
Architect (if applicable)	Name: John Halford Phone: 901.355.9062 Company: PKM Architects		
Total Project Budget:	\$86,954		
Total Grant Requested:	\$30,000		
Property Owner: (If not the applicant)	Name: PKM Phone: 901.355.9062 Email: john@pkmarch.com Mailing Address: 676 Marshall Ave, Ste. 101 Memphis, TN 38103		

Legal Disclosure:	<p><i>Disclose in writing whether any applicant, guarantor, or any other person involved with the project is currently engaged in any civil or criminal proceeding or ever filed for bankruptcy. Also, disclose whether any individual involved with the project has ever been charged or convicted of any felony or currently is under indictment.</i></p> <p>N/A</p>
Board Relationship Disclosure:	<p><i>Disclose in writing whether the applicant or any guarantor has any previous or ongoing relationship with any Board member or legal counsel of the Board.</i></p> <p>N/A</p>
Applicant's Certification:	<p>This application is made in order to induce the CCDC to grant financial incentives to the applicant. The applicant hereby represents that all statements contained herein are true and correct. All information materially significant to the CCDC in its consideration of the application is included. The applicant acknowledges that it has reviewed the descriptions of the CCDC financial program for which it is applying and agrees to comply with those policies. The applicant shall also be required to show best faith efforts with regard to the employment of minority and/or women contractors and subcontractors in the project development. The applicant specifically agrees to pay all reasonable costs, fees and expenses incurred by the CCDC whether or not the incentive is granted or project completed.</p> <div style="display: flex; justify-content: space-between; align-items: flex-end;"> <div data-bbox="597 1627 787 1711">  </div> <div data-bbox="795 1617 950 1711"> <p>Digitally signed by Benjamin Colar Date: 2020.10.22 15:52:08 -05'00'</p> </div> <div data-bbox="1015 1627 1291 1711"> <p>9/23/2021</p> </div> </div> <div style="display: flex; justify-content: space-between; margin-top: 5px;"> Signature: Date: </div>

FINISH LEGEND

- PAINT**
PT-01 (WHITE)
 MANUF: SHERWIN WILLIAMS PRO GREEN 200 OR SIM.
 COLOR: EXTRA WHITE (SW 7006)
- PT-02 (BLACK)**
 MANUF: SHERWIN WILLIAMS PRO GREEN 200 OR SIM.
 COLOR: TRICORN BLACK (SW 7078)
- PT-03 (GRAY)**
 MANUF: SHERWIN WILLIAMS PRO GREEN 200 OR SIM.
 COLOR: HULETT ORE (SW 9574)
- PT-04 (TBD)**
 MANUF: SHERWIN WILLIAMS PRO GREEN 200 OR SIM.
 COLOR: TBD
- PT-05**
 MANUF: TBD
 COLOR: MATCH PT-01
 NOTE: KITCHEN RESILIENT ACRYLIC COATING
- PT-06**
 MANUF: SHERWIN WILLIAMS PRO GREEN 200 OR SIM.
 COLOR: MATCH PT-02
 NOTE: BACK OF BAR RESILIENT ACRYLIC COATING
- WALL BASE**
WB-01
 MATERIAL: PTD. WD.
 SIZE: 1x6
 COLOR: MATCH WALL
- LAMINATES/CABINETS**
PL-01 (WHITE)
PL-02 (BLACK)
- COUNTER TOPS/SURFACES**
SS-01 (QUARTZ)
 MANUF: DALTILE OR SIM.
 COLOR: FRESH LINEN
- SS-02 (SOLID SURFACE)**
 MANUF: DALTILE OR SIM.
 COLOR: FRESH LINEN
- SWITCHPLATES/OUTLET COVERS**
 WHITE UNLESS NOTED OTHERWISE; COORD. WITH ARCHITECT

GENERAL NOTES

1. PAINT FINISH AT GYP. BD. SHALL BE AS FOLLOWS:
 -SEMI-GLOSS AT ALL METAL & WOOD PRODUCTS
 -EGGSHELL AT INTERIOR WALLS
 -FLAT AT GYP. BD. CEILINGS
2. REFER TO INTERIOR ELEVATIONS FOR WALL FINISH DETAILS
3. REFER TO METALWORK SHEETS FOR METALWORK FINISH DETAILS
4. REFER TO REFLECTED CEILING PLANS FOR CLG. FINISH DETAILS
5. REFER TO MILLWORK SHEETS FOR MILLWORK FINISH DETAILS

FLOORING FINISH LEGEND

- T-01 (EXISTING TILE FLR.)**
 MANUF:
 MODEL:
 COLOR:
- C-01 (EXISTING CONCRETE FLR.)**
 MANUF:
 MODEL:
 COLOR:

SITE MATERIAL LEGEND

- CONCRETE WALKWAY, BROOM FINISH
- GRAVEL (TYPE A)
- GROUND COVER: TBD
- EXISTING ASPHALT PAVING
- TREE: TBD

PROPOSED PEDESTRIAN CROSSWALK
 FROM FUTURE PARKING LOT AT 644
 MADISON AVE. N.I.C.

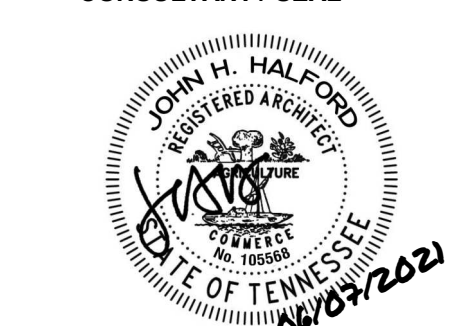
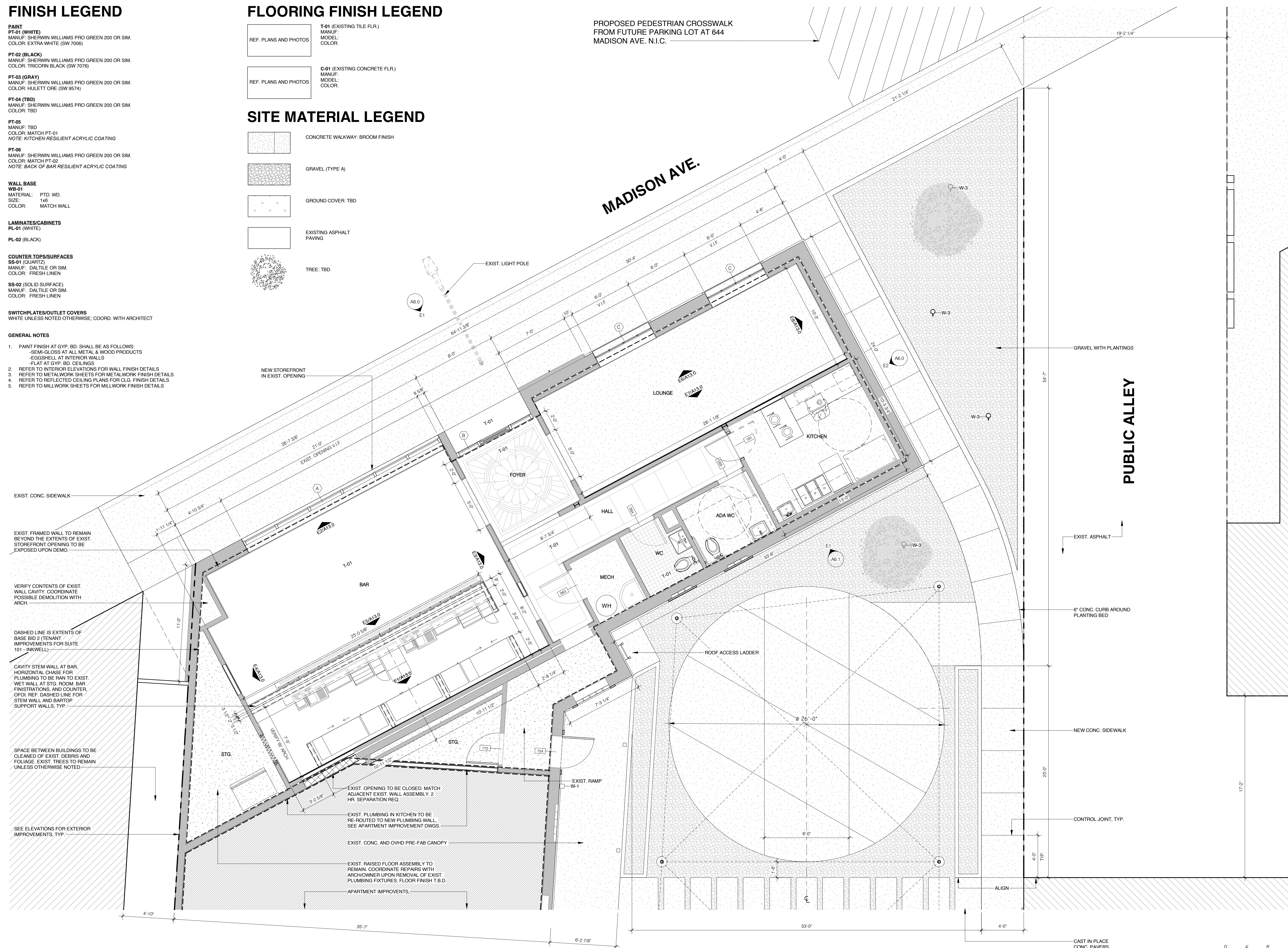

PROJECT LOGO

PROJECT NAME
 631 MADISON

631 MADISON AVE.
 MEMPHIS, TN 38103

PROJECT NUMBER
 20021

REVISIONS

SHEET TITLE
 FLOOR PLANS

DATE
 06/07/2021

SHEET NUMBER
 A1.0